



© 2021 Canin Associates, Inc.

Front View of Harmony West Clubhouse

## Harmonious Collaboration for Creating Community

Building on the success of the Harmony community in Osceola County, our team is now collaborating with the developer, Forestar on building Harmony West. The overall site is just north and west of the original development and eventually will complete the community on the north side of Buck Lake. The Canin Architecture and Landscape Studios have been engaged to provide signage, landscape design and architectural design services for what will be a new 1,800 unit addition to the community of Harmony.

Some of the first design efforts include the streetscape and signage design on Botanic Boulevard which will connect the community from Irlo Bronson Highway to Old Melbourne Highway. The Landscape design features a comfortable walking trail and multiple signage features to identify each neighborhood along the way. The brand new “third place” amenity is also a part of this effort. Construction has just started on this new community facility that will feature a pool and clubhouse designed by our combined studios. The Architecture Studio’s 6,500 square foot clubhouse will have a fitness center, a covered lanai, and a community room that opens to a screened “Florida Room” that features a catering kitchen and ample shaded outdoor seating. The building is designed in a farmhouse style that incorporates modern and rustic elements.

The Landscape Studio’s focus on the outdoor recreation needs of the community inspired a plan that features a large community

“front lawn” for multi-purpose play. The 5,000 square foot resort style pool is complimented by a splash pad family area for additional wet play activities. Other elements of the site include a playground area, picnic pavilion, shade sails, walking trail, sand volleyball courts and a lake side pavilion with an overlook deck on the canal. The plant palette is all Florida Friendly and meets the Toho Water Authority Water Star criteria for design and maintenance. Collaborating with Forestar and internally, the Canin team has created a people place that will be enjoyed by all of Harmony West’s future residents. ■



© 2021 Canin Associates, Inc.

Rear View of Harmony West Clubhouse



## The Hills: A New Community Rising in Minneola



The Hills Park Plan

The Landscape Studio has been hard at work in collaboration with Sunterra Communities in bringing a new community in Minneola to life. The project, initially called the Hills of Minneola, is currently under construction both north and south of the Hancock Road interchange on Florida's Turnpike. Our team has helped create the overall design character, design guidelines and construction documents for multiple phases of the project including the commercial area and Citrus Grove Road that includes two roundabouts. The design character is inspired by the rolling hills of the area with undulating walls and sculptural elements. The streetscapes and parks have a mostly native palette highlighted by native ground covers and canopy trees. ■

## Envisioning a New Direction for Orange County

Orange County (including its cities) is expected to grow in population by almost 50% over the next 30 years. To meet this future, Vision 2050 represents a significant rethinking of the County's approach to growth and land development. Over the last few months our team has assisted with the public roll-out of Vision 2050 through a series of Virtual Town Halls, which provided the public an opportunity to learn about and contribute to this developing plan for the future of the County. The new approach is intended to support multi-modal transportation, encourage redevelopment, and provide a greater range of housing options for current and future County residents. The Town Halls focused on Canin Associates' work, with our teammates at DPZ CoDesign to rethink the County's zoning code and develop policies to support the Vision. ■

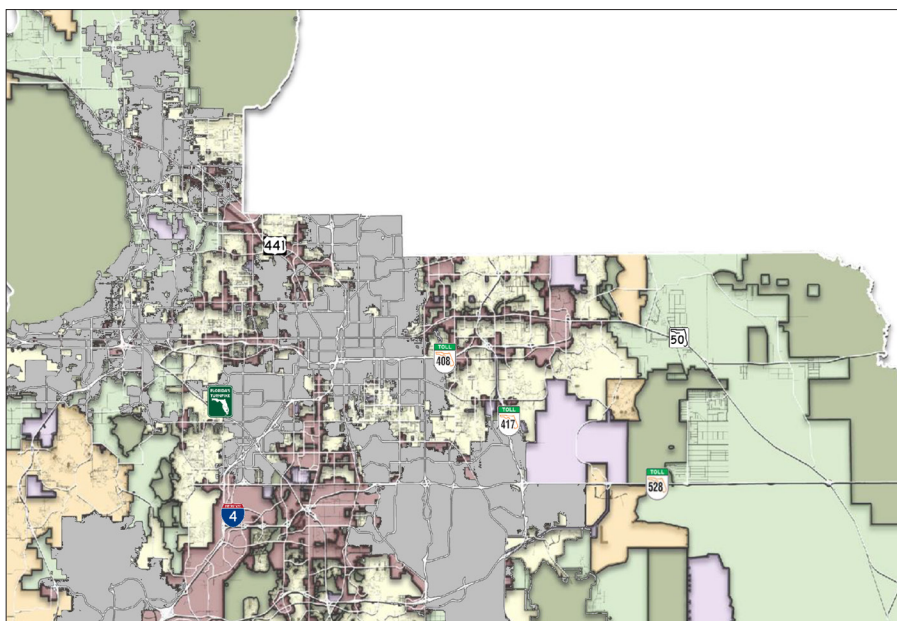

Orange County Sectors



## Creative Couples: Bryn Mawr Attached Duplexes



Traditional and Modern Styled Duplexes

Working within the City of Orlando's strict site development standards for R-2 zoning on two infill lots in College Park, Canin Associates is completing construction documents for four new innovative 1,450 sq. ft., two-story duplex plans that live large with private rear-yard courtyards. Vegetation in the courtyards helps to divide the hardscape and provides a connection to nature for the homeowners overlooking the space.

The duplexes are designed in both traditional and modern styles, and the entrances to the duplexes are on opposite sides of each other, making them feel like independent homes. The two-story duplexes have a one car garage, first floor master bedroom, and two additional bedrooms upstairs. ■

## Star Power: A New Afrotainment Studio



Afrotainment Television Studios

Canin Associates' Architecture Studio has had the opportunity to work on a studio remodel design for Afrotainment. Located on International Drive, the television studio is 30,000 square feet. The existing building lacked character so Canin proposed expanding the center of the existing façade and incorporating a marquee sign above the

building entrance. The interior of the building becomes part of the façade with glass windows, that allow a series of posters to be viewed from the exterior of the building. The interior of the building contains a theater, offices, and studio spaces. The remodel of this building creates a fully equipped space for Afrotainment to produce high quality content. ■

## the buzz at CANIN

Greg Witherspoon will be presenting a session on landscape codes for Florida ASLA on October 14th. Tune in for updates on new design codes in Florida. Greg also recently obtained a professional landscape architect license in the state of Tennessee.

Eliza Juliano presented at CNU on new urban guild transportation. She will provide regular annual updates on the topic.

All of our studios are growing with several new hires this year. Check our web page regularly for new career opportunities.

## The Value of Green

Our Landscape studio was recently engaged by a client in Panama to help increase the value of the natural riverine environment on their project. The result is a park with a series of trail typologies that allow for active recreation above the river bank and an elevated pedestrian path that engages with the river while protecting the habitat.

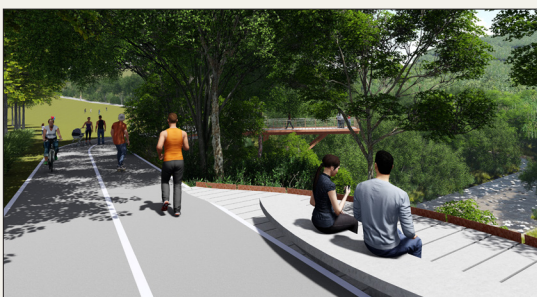

Multi-use Trail in Panama

## on the boards at CANIN

The Landscape Studio is in the beginning stages of designs for Silverleaf, a master planned community in western Orange County. Currently, we are working to create iconic signage, which will make this project stand out among other communities in the Horizon West area.

The Architecture Studio is working on a brand new series of homes for Cross Prairie, the first development in the Edgewater DRI. The plans include three product lines with floor plans focused on space efficiency for comfort and flexibility.

The Planning Studio has been awarded continuing services contracts for the Cities of Edgewater and Titusville. Each contract will build upon the urban planning design work we previously developed.

The Landscape Studio recently completed a design package for the Charleston division of David Weekley Homes. The challenge was to add value and utility to small, constrained courtyards. Adding some Charleston flair with local materials helped create the desired effect.



Encore: Charleston, SC